

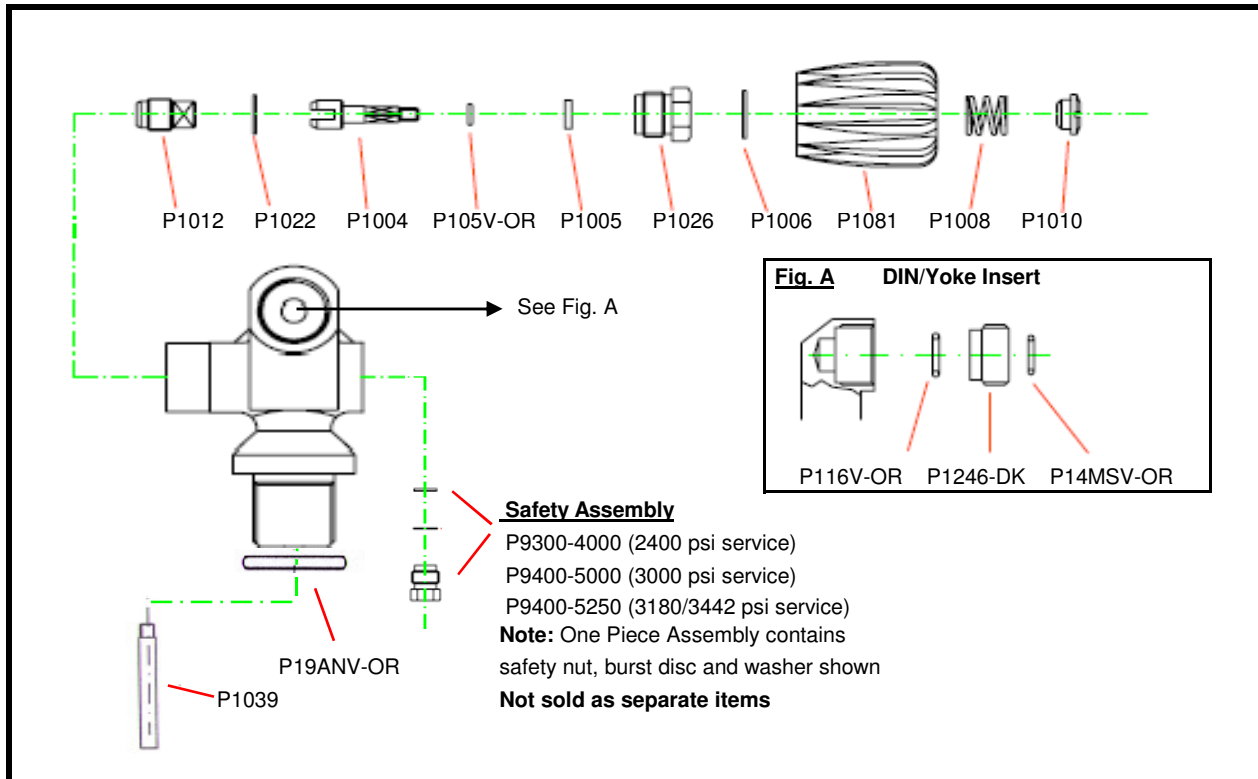

## Exploded View



**For Valve Models: 10111, 10112, 10120 and 10113 (DIN only, no insert)**

Refer to Valve Repair Parts list for part number descriptions.  
Valve maintenance should only be performed by qualified personnel.

**Note: Only Oxygen Compatible Lubricant should be used when replacing parts**

**Torque Values :** Packing Nut 29 - 30 Ft Lbs maximum  
Safety Assembly - 11 Ft Lbs maximum  
DIN/Yoke Insert - 15 Ft Lbs maximum

**Only Blue Steel LLC. OEM parts should be used in repairing or refurbishing of Blue Steel LLC. Valves. The use of other manufacturers valve parts in Blue Steel LLC. valves is not recommended and may result in failure of valve to operate properly and void any warranty implied or offered.**